

TI-6,3

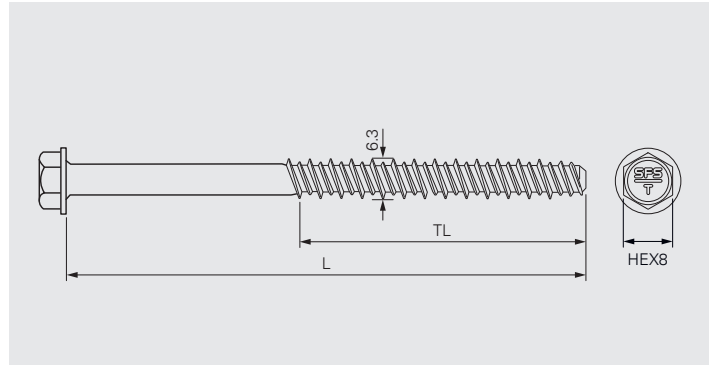

Application

Carbon steel fastener for waterproof membrane and insulation securement on concrete deck.

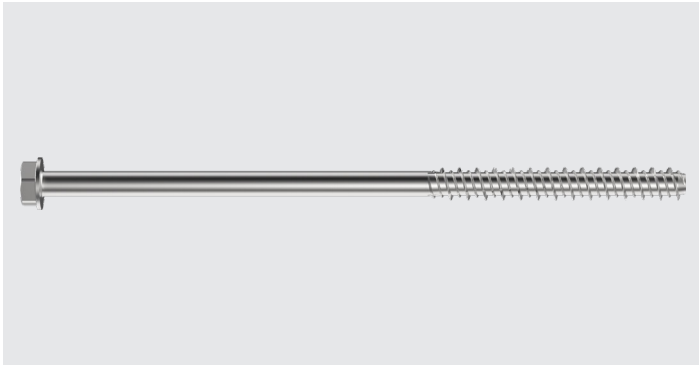
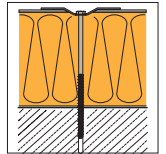

Substrate material quality:	min. C12/15
Substrate material thickness:	min. 40 mm
Pre-drill diameter:	5.0 mm, see "Tools and Accessories" for alternative drill diameters
Setting depth:	min. 20 mm
Fastener length L:	Clamping length CL + min. 20 mm
Depth of pilot hole:	min. 15 mm deeper than setting depth

Product Information

Material:	Case hardened carbon steel
Corrosion protection:	Durocoat® Resistance 15 cycles Kesternich test according to <ul style="list-style-type: none"> • EAD 030351-00-0402, A2.4 • FM Approval Standard 4470

Approvals/Assessments



Declaration of Performance (DoP)



Features and Benefits

- Fast and easy installation, pre-drill and screw
- Plug free installation
- Only 20 mm setting depth required
- Removable
- High quality corrosion protection, environment friendly, free of Chromium VI

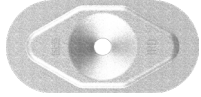

Product Range

Product Code	L _{mm}	TL _{mm}	PU	Material No.
TI-6,3×25	25	22	500	1237838
TI-6,3×32	32	29	500	1237839
TI-6,3×45	45	42	500	1237840
TI-6,3×55	55	50	250	1237841
TI-6,3×65	65	50	250	1237852
TI-6,3×75	75	50	250	1237853
TI-6,3×85	85	50	250	1237854
TI-6,3×95	95	50	250	1237855
TI-6,3×105	105	50	100	1237856
TI-6,3×115	115	50	100	1237857
TI-6,3×125	125	50	100	1237859
TI-6,3×135	135	50	100	1237860
TI-6,3×145	145	50	100	1237861
TI-6,3×155	155	50	100	1237862
TI-6,3×165	165	50	100	1261024
TI-6,3×175	175	50	100	1261025
TI-6,3×185	185	50	100	1261026
TI-6,3×195	195	50	100	1261027
TI-6,3×205	205	50	100	1261028
TI-6,3×215	215	50	100	1261029
TI-6,3×235	235	50	100	1261030
TI-6,3×255	255	50	100	1261032
TI-6,3×275	275	50	100	1261033

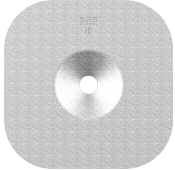
Products to combine with

Product Code	Description	
IRD-82×40	Stress plate for waterproof membrane and insulation securement. For seam fastening application.	
IF/IG-C-82×40	Convex stress plate for waterproof membrane and insulation securement. For seam fastening application, on hard substrate.	
ID-70×70	Stress plate for insulation securement.	

Tools and Accessories

Product Code	Description	
SDS-5,0×L/L-SP SDS-4,8×L/L-SP* SDS-5,2×L/L-SP*	SDS drill bit	
ZA 1/4"	Drive bar for socket, for manual fastener installation	
E380-3/8"-34	Socket for fastener with HEX 8 head, for manual fastener installation	

* Alternative drill diameter depending on local conditions. The optimum drill diameter can be determined via on-site pull-out tests.

Recommendations for Installation

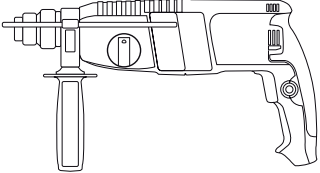
Operating process	Recommendation	
Pre-drilling	Hammer drill with weight class 2–3 kg, impact energy $\leq 2,5$ J	
Screwing in	Power screwdriver <ul style="list-style-type: none"> • 300–700 rpm • Min. 500 W Battery tool <ul style="list-style-type: none"> • 300–700 rpm • Min. 18 V • Battery with min. 2,5 Ah Do not use a percussion tool	