

FI-P-16,0

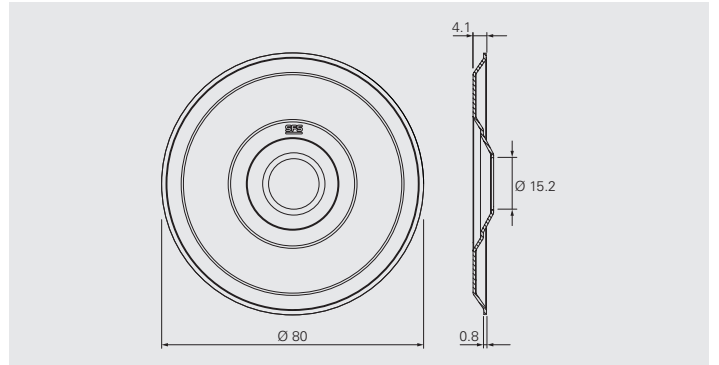
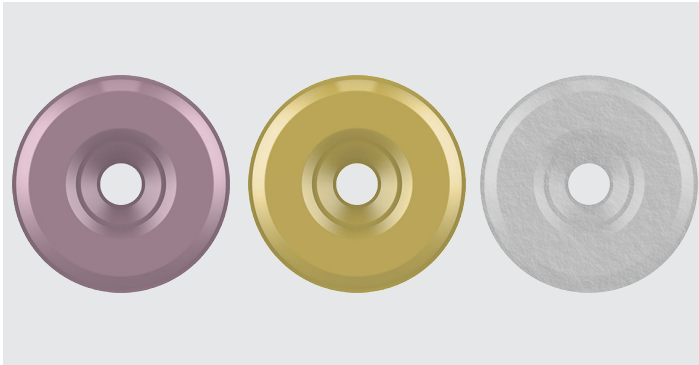

Application

Stress plates for PVC, TPO and EPDM based waterproof membranes in combination with sleeve FI-R-20.

For isoweld® field fastening application.

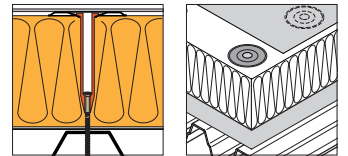

Product Information

Material:	Carbon steel, zinc plated
Corrosion protection:	Resistance 15 cycles Kesternich test according to <ul style="list-style-type: none"> • EAD 030351-00-0402, A2.4 • FM Approval Standard 4470

Approvals/Assessments

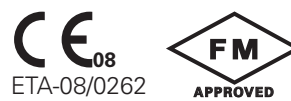



Declaration of Performance (DoP)



Product Range

Product Code	Description	PU	Material No.
FI-P-16,0-PVC	For PVC based waterproof membrane	200	1326161
FI-P-16,0-TPO	For TPO based waterproof membrane	200	1326162
FI-P-16,0-EPDM	For EPDM based waterproof membrane	200	1326164

Products to combine with

Product Code	Description	
FI-R-20	Sleeve for waterproof membrane and insulation securement. For isoweld® field fastening and seam fastening applications.	
FI-PAD	Cardboard pad in combination with stress plates FI-P-6,8 and FI-P-16,0 for applications on EPS/XPS insulation boards.	

Tools and Accessories

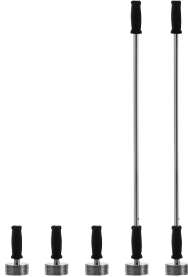
Product Code	Description	
ISOWELD3000	User-friendly and ergonomic stand-up induction welding tool for use with the isoweld® field fastening system for welding PVC, TPO/FPO and EPDM based waterproofing membranes to the FI-P stress plate.	
ISOWELD3000M	User-friendly mobile induction welding tool for use with the isoweld® field fastening system for welding PVC, TPO, FPO and EPDM based waterproofing membranes to the FI-P stress plate, in narrow and tight roof spaces.	
FI-H	isoweld® hand inductor, with flexible 6 m cable, for use in narrow and tight roof spaces and on verticals, used in combination with isoweld® 3000 and isoweld® 3000m induction welding tools.	
FI-MAGNET SET	Set of 10 magnetic heatsink for use with the isoweld® field fastening system. Positioned on the waterproofing membrane over the FI-P stress plate to apply pressure and to disipate heat. Extension rods included for working in an up-right position.	
FI-SUCTION CUP	Suction Cup for conducting welding tests.	